

UNITED

BATCH # :

L A B O R A T O R I E S

PREVENTS AND REPAIRS FLAT TIRES ON:

- Landscaping Equipment • ATV's • Mowers
- Cars and Trucks • Industrial and Ag Equipment

P.S.I. Super Duty Tire Sealant

- Instantly seals punctures up to 1/4"
- Prevents and repairs flats and leaks
- Easily installs with the tools supplied
- Long lasting, easy to install

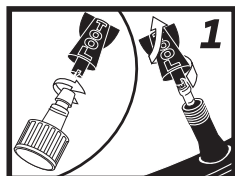

1. Remove Valve Core

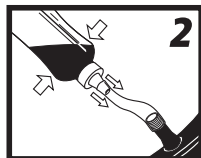

2. Install Sealant



3. Replace Valve Core



4. Air Up Tire

INSTALLATION INSTRUCTIONS:

NOTE: Air source required to reinflate tire after application.

1. The black cap is a valve core removal tool. Unscrew this tool from the top of the cap, and use it to remove the valve core from inside the valve stem.

2. Attach the provided filler tube to both the bottle and valve stem. Squeeze in the recommended amount of sealant.

3. Screw valve core back into tire valve stem.

4. Inflate tire to recommended air pressure indicated on the outside of your tire. Spin the tire to distribute sealant to the puncture area if being used as a repair.

NOTE: If the tire deflates after installation of sealant, examine tire to confirm there are no punctures larger than

1/4". Remove any puncturing objects then reinflate tire and immediately spin tire to distribute sealant to the puncture.

Printed in U.S.A.

407

PUNCTURE SEALING INNOVATION

Super Duty Tire Sealant

UNITED 40

KEEP OUT OF REACH OF CHILDREN.

CAUTION

SEE SIDE PANEL FOR ADDITIONAL PRECAUTIONARY STATEMENTS.

PRECAUCION AL USARIO: Si usted no puede leer Ingles, pregunte a alguien que le traduzca esta etiqueta para usted antes de uso.

UNITED LABORATORIES, INC.

320 37th Avenue • St. Charles, IL 60174

1-800-323-2594 • www.unitedlabsinc.com

APPLICATION FORMULA:

For Low Speed Tires (under 45 mph / 75 km):

H Height (inches) x **W** Width (inches) x .12 = Ounces required

For High Speed Tires (over 45 mph / 75 km):

H Height (inches) x **W** Width (inches) x .065 = Ounces required*



* Older tires may require an extra 1 to 2 oz of P.S.I.

APPLICATION GUIDE FOR 1 TIRE:

| Tire Type | Amount |
|------------------------|--------------------------------|
| Passenger Car, Trailer | 8 to 14 oz (236 to 415 ml) |
| Wheelbarrow | 12 to 16 oz (355 to 473 ml) |
| Light Utility | 12 to 16 oz (355 to 473 ml) |
| 4x4 Truck, Golf Cart | 16 to 20 oz (473 to 591 ml) |
| Riding Mower, ATV | 16 to 20 oz (473 to 591 ml) |

WARNING:

P.S.I. will not seal sidewall punctures and should not be used with faulty valves or damaged rims. **P.S.I.** will seal most punctures up to 1/4"; however, for safety have tire inspected and, if necessary, repaired by a professional as soon as possible after puncture occurs. Not for use with major tire damage. Do not use this product with any other sealant. For high speed application (over 45 mph/75 kph) use only as a repair (exception/trailor tires). May cause excessive vibration when installed in front or all four tires. Do not exceed recommended application quantities. May affect tire balance. This product is not recommended for inner tubes.

CAUTION:

Do not ingest. May cause stomach discomfort or diarrhea. If swallowed, consult a physician. Eye protection should be worn during installation.

An MSDS for this product has been provided. Please read it carefully and follow all instructions when using or handling this product. Never reuse empty containers. Incompatible materials may adversely react.